

50-S-61 - SPEEDLINE System Data Sheet - Version V1 (24-10-23)

SPEEDLINE 50mm 'C' Stud Partition @600mm Ctrs,
with 2x Siniat GTEC 12.5mm Fire Board each side

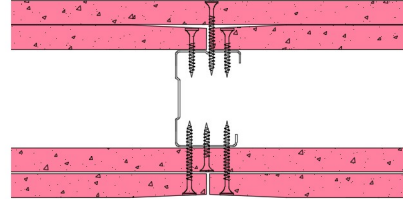

System Performance Breakdown

Fire Resistance:

BS476 Part 22:1987:

Test Ref & Date or Applied Ref & Report:

Max Height:

Thickness:

Duty Grade: BS 5234: Part 2:1992:

Sound Insulation:

90/90 Minutes (Integrity/Insulation).

BTC 17445F - BRE Report P102396-1011C

Refer to Speedline Specification Clause

102 mm. (At Base Track, Excluding Finishes)

Severe - Annexes A-F

42 R_w dB, Date Tested or Assessed Against - 50-S-57

| | |
|------------|------------|
| Test Code: | H17501AA |
| Test Date: | 26/07/2011 |

| Freq. Hz | R dB |
|----------|------|
| 50 | 22.2 |
| 63 | 16.3 |
| 80 | 12.6 |
| 100 | 12.6 |
| 125 | 16.6 |
| 160 | 27.1 |
| 200 | 30.7 |
| 250 | 31.0 |
| 315 | 34.9 |
| 400 | 41.1 |
| 500 | 46.8 |
| 630 | 48.0 |
| 800 | 51.4 |
| 1 000 | 52.5 |
| 1 250 | 55.4 |
| 1 600 | 58.3 |
| 2 000 | 57.4 |
| 2 500 | 47.3 |
| 3 150 | 45.8 |
| 4 000 | 50.3 |
| 5 000 | 52.0 |
| 6 300 | |
| 8 000 | |
| 10 000 | |

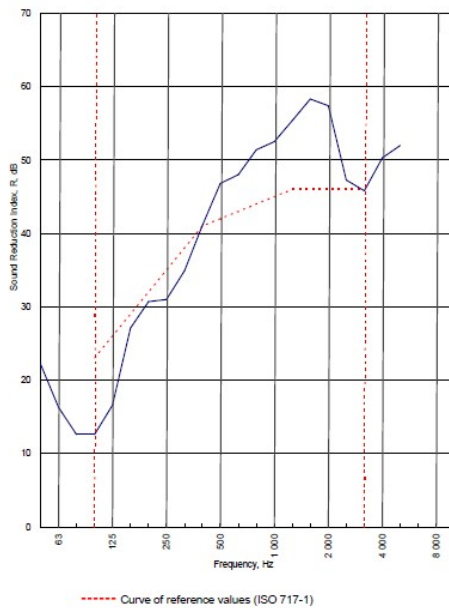

| | | | |
|---|--|----------------------------------|-----------------------------------|
| Rating according to BS EN ISO 717-1:1997 | $R_w (C;Ctr) = 42 (-4;-11) \text{ dB}$ | | |
| Evaluation based on laboratory measurement results obtained by an engineering method: | $C_{50-3150} = -5 \text{ dB}$ | $C_{50-5000} = -4 \text{ dB}$ | $C_{100-5000} = -3 \text{ dB}$ |
| | $C_{1,50-3150} = -14 \text{ dB}$ | $C_{1,50-5000} = -14 \text{ dB}$ | $C_{1,100-5000} = -11 \text{ dB}$ |

TESTED AT ONE OF THE UKAS ACCREDITED LABORATORIES BELOW

B.T.C (H-Ref on Graph)

B.R.E

AIRO

S.R.L

Customer: Metsec plc Hepsec Division



BTC 17501A: Page 8 of 10

